



Description MINIATURE CIRCUIT BREAKER

Code MT 60

No. of poles 4P

No. modules 4

Rated current 50 A

Curve C

Rated voltage 230-400 V

| | | | |
|---|---|---|---|
| Standard | EN 60898, EN 60947-2 | Rated frequency (Hz) | 50/60 Hz |
| Breaking capacity EN 60898 230V (Icn) | 6000 A | Breaking capacity EN 60898 400V (Icn) | 6000 A |
| Breaking capacity EN 60898 (Ics) | 1 x Icn | Breaking capacity IEC/EN 60947-2 230V (Icu) | 20 kA |
| Breaking capacity IEC/EN 60947-2 400V (Icu) | 10 kA | Breaking capacity IEC/EN 60947-2 (Ics) | 75% Icu |
| Insulation voltage (Ui) | 500 V | Rated impulse withstand voltage (Uimp) | 4 kV |
| Minimum operating voltage | 12V ac/dc | Maximum operating voltage | 440V AC / 220V DC |
| Electrical endurance | 10.000 | Mechanical endurance | 20.000 |
| Section rigid cable | <=1x35 - <=2x16 - <=1x16+2x10 mm ² | Section flexible cable | <=1x35 - <=2x16 - <=1x16+2x10 mm ² |
| Rated tightening torque | 2 Nm | Operating temperature | -25 +60 °C |
| Stocking temperature | -40°C ÷ +70°C | Electrocod | 1411 |

DIMENSIONAL

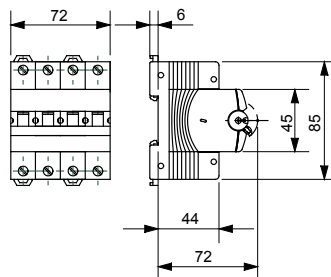

STANDARDS/APPROVALS

