



Description MINIATURE CIRCUIT BREAKER

Code MT 250

No. of poles 4P

No. modules 4

Rated current 10 A

Curve C

Rated voltage 230-400 V

Standard	EN 60898, EN 60947-2	Rated frequency (Hz)	50/60 Hz
Breaking capacity EN 60898 230V (Icn)	25000 A	Breaking capacity EN 60898 400V (Icn)	25000 A
Breaking capacity EN 60898 (Ics)	0.5 x Icn	Breaking capacity IEC/EN 60947-2 230V (Icu)	40 kA
Breaking capacity IEC/EN 60947-2 400V (Icu)	25 kA	Breaking capacity IEC/EN 60947-2 (Ics)	50% Icu
Insulation voltage (Ui)	500 V	Rated impulse withstand voltage (Uimp)	4 kV
Minimum operating voltage	12V ac/dc	Maximum operating voltage	440V AC / 220V DC
Electrical endurance	10.000	Mechanical endurance	20.000
Section rigid cable	<=1x35 - <=2x16 - <=1x16+2x10 mm ²	Section flexible cable	<=1x35 - <=2x16 - <=1x16+2x10 mm ²
Rated tightening torque	2 Nm	Operating temperature	-25 +60 °C
Stocking temperature	-40°C ÷ +70°C	Electrocod	1411

DIMENSIONAL

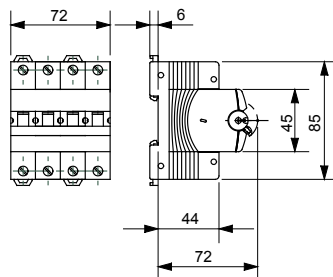

STANDARDS/APPROVALS

