



Range 44 CE - Surface-mounting watertight junction boxes in compliance with EN 60670-1 (CEI 23-48) and IEC 60670-22 (CEI 23-94) and made in high-performance technopolymers. The range includes versions with protection degree IP44, IP55, IP56 with smooth walls or with quick entry cable glands and different type of covers: blind / transparent, deep/plain, press-on/screw (in plastic, also 1/4 turn, or in metal). Available in different self-extinguishing materials (up to GWT 960 °C). Suitable for ordinary junctions, for special uses, and for industrial uses.

|                                      |                                       |                           |                          |
|--------------------------------------|---------------------------------------|---------------------------|--------------------------|
| Insulation class                     | II (according to IEC 61140 standards) | Colour                    | Grey RAL 7035            |
| IP degree                            | IP56                                  | Material                  | Technopolymer GWPLAST 75 |
| Mechanical resistance                | IK08                                  | Internal dim. LxHxD (mm)  | 380x300x180              |
| Max Ø holes possible                 | 48 mm                                 | Lid screws (no. and type) | 4 insul. sealable hinged |
| Application                          | Special uses                          | Glow Wire Test            | 960 °C                   |
| Lid                                  | Deep screwed                          | Operating temperature     | -25 +60 °C               |
| Electrocod                           | 02211                                 | Thermo-pressure with ball | 85 °C                    |
| Torque screws tightening             | 1.8 Newton/meter                      | Walls                     | Smooth                   |
| Accessories for insulation restoring | GW44621, GW44623                      |                           |                          |

#### BEHAVIOUR WITH CHEMICAL AND ATMOSPHERIC AGENTS

| Saline solution | Acids              |           | Bases        |           | Solvents           |               |               |                    | Mineral oil        | UV rays            |
|-----------------|--------------------|-----------|--------------|-----------|--------------------|---------------|---------------|--------------------|--------------------|--------------------|
|                 | Concentrated       | Diluted   | Concentrated | Diluted   | Hexane             | Benzol        | Acetone       | Alcohol            |                    |                    |
| Resistant       | Limited resistance | Resistant | Resistant    | Resistant | Limited resistance | Not resistant | Not resistant | Limited resistance | Limited resistance | Limited resistance |

#### DIMENSIONAL

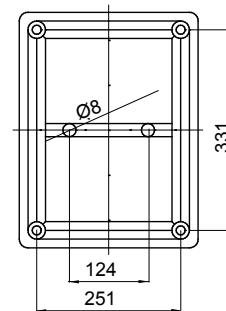
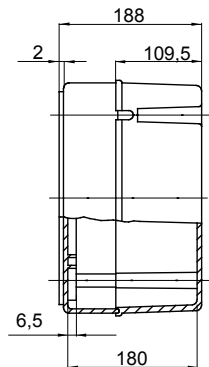
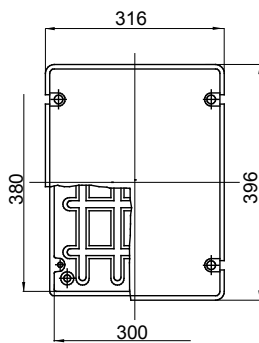

#### TECHNICAL SYMBOLOGY



II (according to IEC 61140 standards)

IP

IP56

IK

IK08

GWT

960 °C

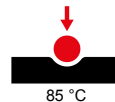

#### STANDARDS/APPROVALS

