

# GE25012KF

PN: BTVGCBE0GHYKFCW01B  
EAN: 6422956013462

## Specifications

Battery Model	GE25012KF
Voltage	12V
Power (1.65V/cell@15min)	725 W/cell
Type	Valve regulated lead-acid (VRLA), 6 cell, GEL - maintenance free
Designed Floating Life	Up to 12 years (25°C) Eurobat (20°C) : 10 - 12 years standard commercial
Nominal Operating Temp. Range	25°C ± 3°C
Terminal	T11 Copper (M8 bolt)
<b>Construction</b>	
Container & Cover	ABS
Safety valve	EPDR
Terminal	M8 Copper
Self Discharge (25°C)	after 3 month storage 92% after 6 month storage 84%
<b>Capacity affected by temperature</b>	
40°C	103%
25°C	100%
0°C	90%
<b>Charge Voltage (25°C)</b>	
Cycle use	13.5V - 13.8V max. Current: 75A
Float use	13.5V - 13.8V
Internal resistance	≤ 4.0 mΩ
<b>Physical</b>	
Without Terminal	522x 268 x 218 mm
With Terminal	522x 268 x 226 mm
Product Weight	68.5 kg



Completely sealed and maintenance-free



Excellent charging and re-charging



Long Life & low self-discharge design

- Gel deep cycle technology
- Excellent charging and re-charging
- Stable and reliable for long-term
- Low self-discharge
- Floating & standby use: 12 years
- More than 400 cycles at 100% DOD
- Multiple Application: Alarm and Security Systems, Cable Television, Communication Equipment, Power Tools, Control Equipment, Medical Equipment, UPS, Toys, Solar Systems

## Constant voltage charging characteristic (0.25 CA, at 25°C)

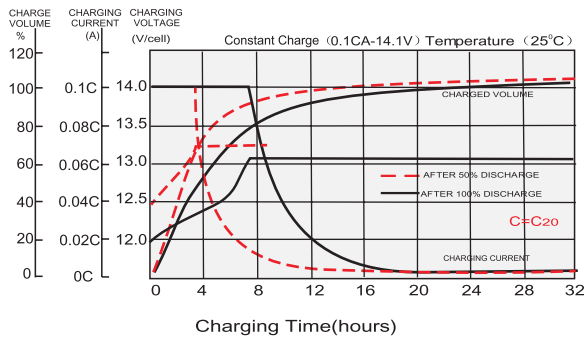

## Temperature Effects in Relation to Battery Capacity

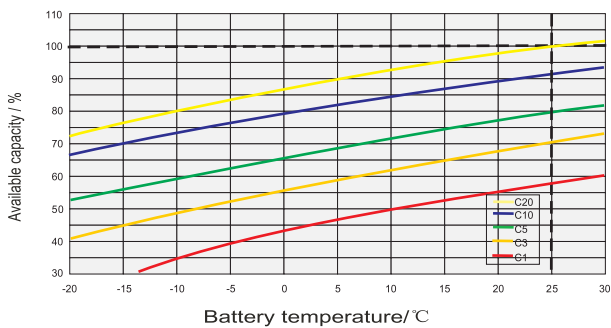

## Cycle Life in Relation to Depth of Discharge

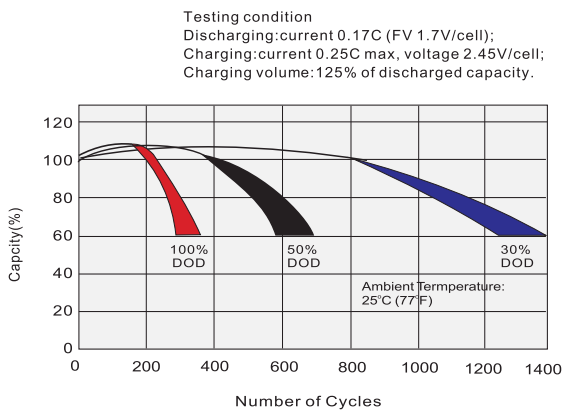

## Discharge Characteristics

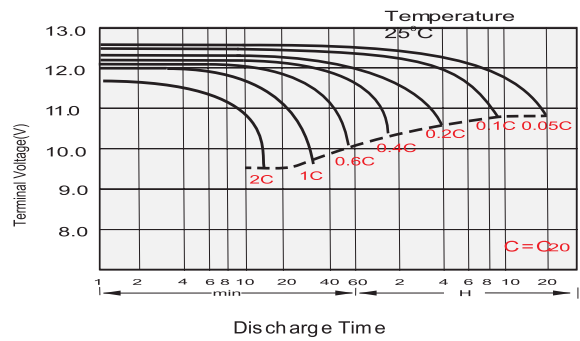

## Effect of Temperature on Long Term Float Life

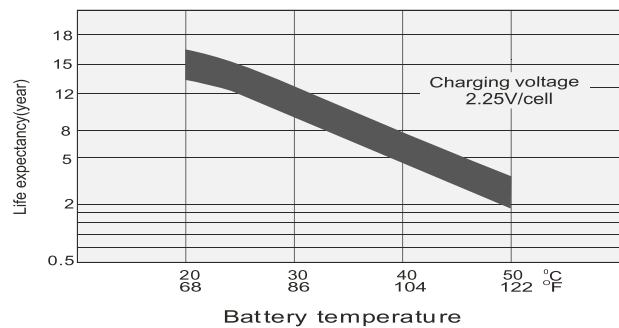

## Self Discharge Characteristics

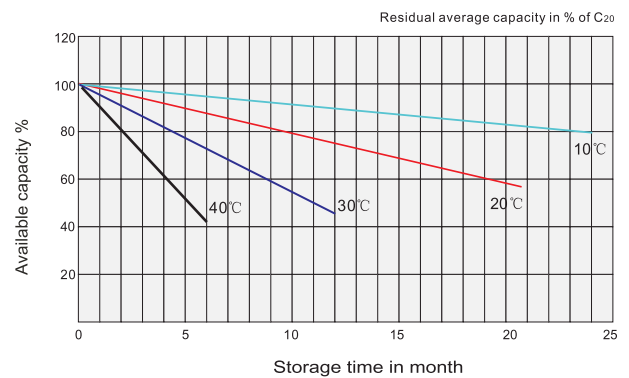

## Dimensions (mm)

## T8 Terminal Dimensions (mm)

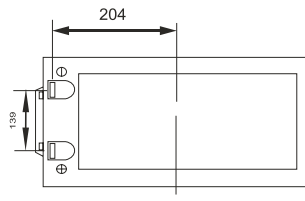
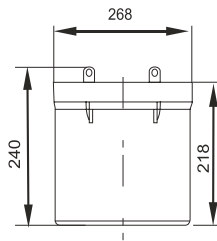
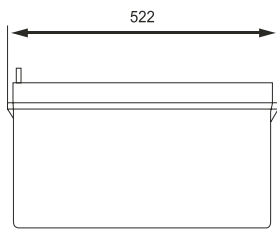

### Terminal Unit: mm [inches]

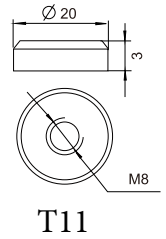
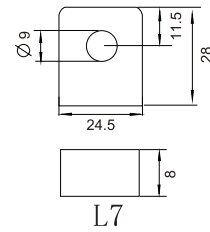



## Constant Current Discharge Characteristics (A), 25°C

F.V/Ti	15min	30min	60min	2Hr	3Hr	5Hr	8Hr	10Hr	20Hr
1.80V/cell	325	226	140	95.7	62.7	42.7	29.3	24.0	13.0
1.75V/cell	365	246	145	87.9	64.1	43.3	30.1	25.0	13.1
1.70V/cell	398	251	151	92.5	64.7	43.8	30.3	25.4	13.2
1.65V/cell	420	256	155	94.8	65.2	44.3	30.5	25.4	13.3
1.60V/cell	439	259	158	95.7	65.6	44.6	30.7	25.5	13.4

## Constant Wattage Discharge Characteristics (W), 25°C

F.V/Ti	15min	30min	60min	2Hr	3Hr	5Hr	8Hr	10Hr	20Hr
1.80V/cell	635	415	258	158	122	84.0	58.1	49.8	25
1.75V/cell	670	447	267	163	126	86.6	59.8	50.0	26
1.70V/cell	698	452	279	171	127	87.2	60.4	50.2	26
1.65V/cell	725	457	281	174	128	87.6	61.0	50.4	27
1.60V/cell	740	459	286	175	129	88.3	61.2	50.6 2	27

## Logistics

	Carton Box Size	525 x 275 x 278 mm
	Pieces in the Carton Box	1 pc / ctn
	Net & Gross weight / CTN	N.W. / G.W.: 68.5 kg / 69 kg

